



# ORTHOPEDIC SUPPORTS

## For Pediatrics / Youth



**Anatomically Correct Designs for Kids** ...Our designs are based on actual anthropometric data from children – not just scaled down adult products. *See inside page for more details.*

**FOR RETAIL/HME DEALERS**



### Canvas Rocker Bottom Cast Shoe

- Provides protection for walking casts
- Durable canvas material with adjustable closures
- Open toe and heel
- Non-skid sole
- Fits right or left

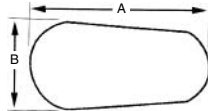

Order # EA	Size	Sole Dimensions		Color
		A	B	
43-101107	INFANT	5 1/2"	3"	Pediatric print
43-101204	PED	7 1/4"	3 3/8"	Navy
REGULAR LINE		Sole Dimensions		Color
Order # EA	Size	A	B	
43-101408	YOUTH/SM	9 3/8"	4 1/4"	Navy



### Clavicle Support

- Holds shoulders back and limits clavicle movement during treatment of clavicular fractures
- Felt back panel for greater support
- Adjustable top straps for an excellent fit
- Padded straps for comfort

#### Indications:

- Treatment of Clavicular Fractures



Order # EA	Size	Approx. Age	Fits Chests
16-101106	INFANT	0-24 mos	15 - 20"
16-101307	PED/XS	2-7 yrs	20 - 24"
REGULAR LINE		Approx. Age	Fits Chests
Order # EA	Size	Approx. Age	Fits Chests
16-101404	YOUTH/SM	8-12 yrs	24 - 30"



### Cervical Collar

- Soft foam treated with Microban® Anti-Microbial Protection for a fresher, more hygienic product
- Low contour maintains head in neutral position
- Simple application with hook and loop closures



Order # EA	Size	Approx. Age	Neck Circumference	Collar Width x Length
11-111101	INFANT	0-24 mos	9 - 10 1/2"	2 x 13"
11-121202	PED	2-7 yrs	10 - 12"	2 1/2 x 15"
11-131306	YOUTH	8-12 yrs	12 - 14"	2 1/2 x 17"



### Elastic Shoulder Immobilizer

- Lightweight, low profile
- Immobilizes shoulder, reduces abduction and arm rotation
- Loop lock closures for easy application
- Fits right or left



Order # EA	Size	Approx. Age	Fits Chests
16-701104	INFANT	0-24 mos	16 - 22"
16-701301	PED/XS	2-7 yrs	20 - 26"
REGULAR LINE		Approx. Age	Fits Chests
Order # EA	Size	Approx. Age	Fits Chests
16-701408	YOUTH/SM	8-12 yrs	24 - 30"